

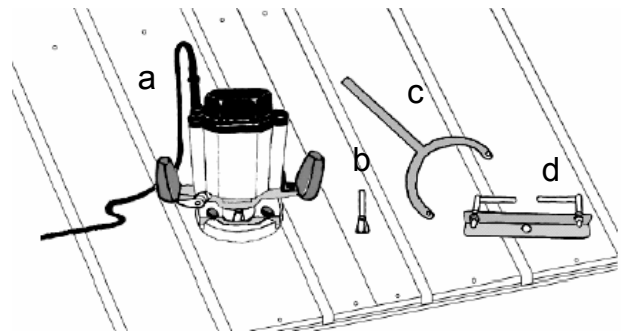

Fresing av vendespor i Orkla Thermogulv

For å foreta fresing på byggeplass trengs følgende:

- a Handoverfres
- b Profilfres
- c Fresemal
- d Sirkelføringsbrakett



1 Sirkelføringsbrakett påmonteres handoverfres.

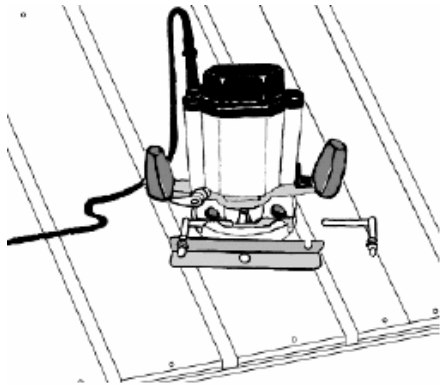

2 Fresemal legges ned i ferdig frest spor i platen på det sted man ønsker.

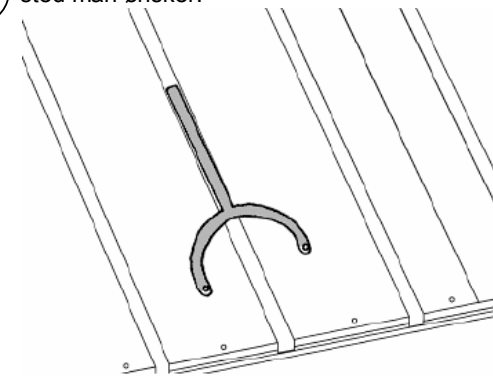

3 Handoverfres påmontert profilfres og sirkelføringsbrakett settes ned i allerede freste spor.

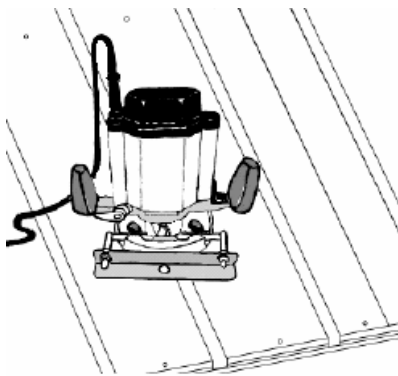

4a Hullet i sirkelføringsbraketten skal nå passe til "tappen" på fresemalen.

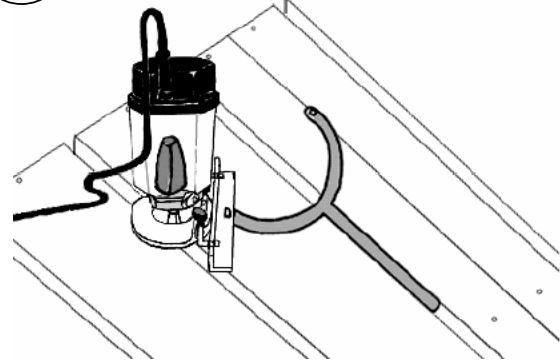

4b

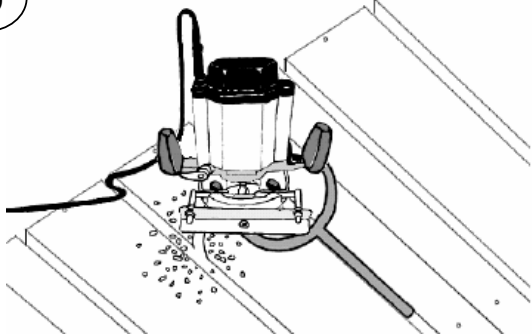

4c

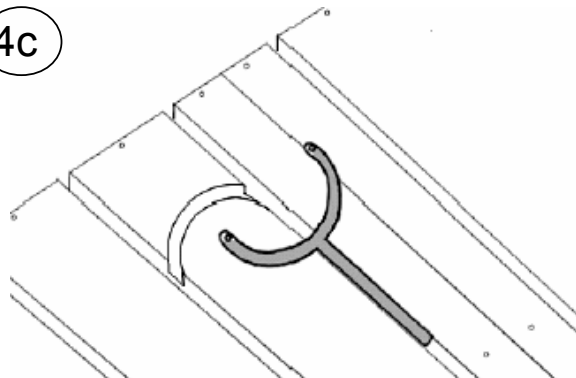

Må eventuelt fresas to ganger for nødvendig spordybde.

