



# Vinkelbeslag V15

## Angle connectors V15

### Winkelverbinder V15

#### DK

**Anvendelse:** Vinkelbeslag V15 anvendes til krydssamlinger.

**Beslagene:** Er udført i 3 mm varmforzinket stålplade forsynet med Ø5 mm huller for 4 mm NKT beslagkamsøm eller 5 mm NKT beslagskruer.

**Montering:** Den korte flig anbringes vandret og udsømmes fuldt. I lodret flig sømnes 4-10 søm.

#### UK

**Application:** Angle connectors V15 are used for cross joints.

**Connectors:** Made in 3 mm hot galvanized steel plate provided with 5 mm holes for 4 mm NKT anchor nails or 5 mm NKT connector screws.

**Fitting:** The short flange is placed horizontally and fully nailed. In the vertical flange, 4-10 nails are nailed.

#### D

**Anwendung:** Winkelverbinder V15 sind für Kreuzverbindungen einzusetzen.

**Ausführung:** Die Winkelverbinder sind aus 3 mm feuerverzinkter Stahlplatte gefertigt und mit Ø5 mm Löchern für 4 mm NKT Ankernägeln oder 5 mm NKT Beschlagschrauben ausgerüstet.

**Montage:** Der kurze Schenkel ist waagrecht anzubringen und völlig auszunageln. In den senkrechten Schenkel sind 4-10 Nägel einzuschlagen.

SIMA art. no.	Type	Dimension				Ø mm Ø5 mm	Weight gram	Pcs. Box / Pallet
		H	L	t	B			
211062	V15	120	90	3	40	16	180	50 / 3200 CE

Fig. 1

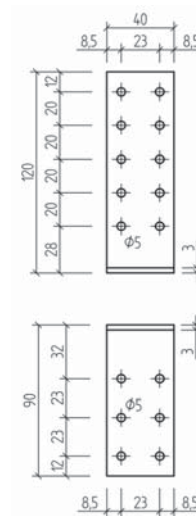
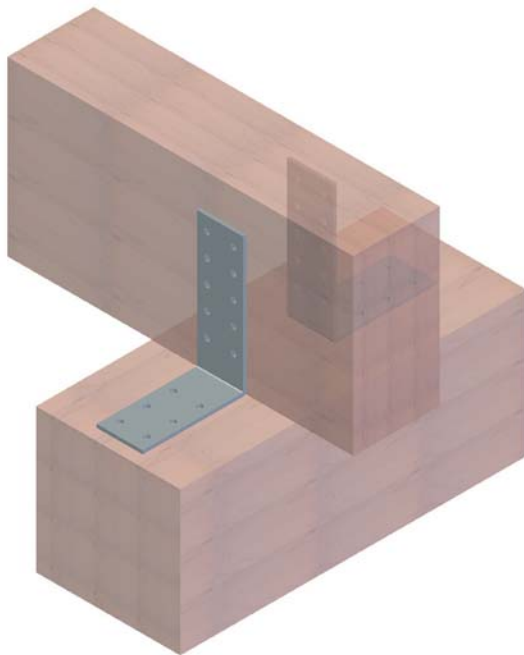

# Angle connector V15

Art. no.	Type	Dimension H x L x t x B [mm]	Hole Ø5 [pcs]	Weight [g]	Box [pcs]
211062	V15	120 x 90 x 3,0 x 40	16	180	100

Information referring to the product, its applications and fitting: See section 2

Calculative carrying capacity in kN per connection:  
Normal safety class – service class 1 and 2

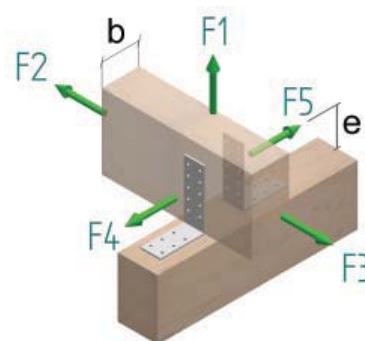

b and e should be inserted in mm

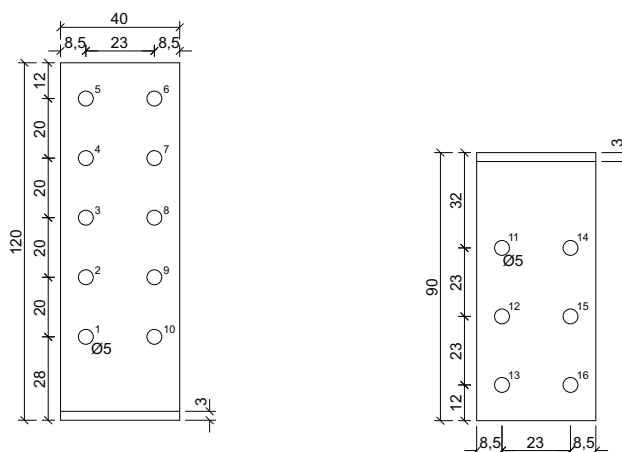

Anchor nail 4,0 x 40	Number of nails	Load-duration class	F <sub>1d</sub> [kN]	F <sub>2d</sub> = F <sub>3d</sub> [kN]	F <sub>4d</sub> = F <sub>5d</sub> [kN]	Maximum [kN]
2,5,6,9 / 11,13,14,16	16	Char.	2,87	4,37	$1,08 * ((1,76*(42,9+b))/e)$ or $1,08 * ((14,25*(3+b))/e)$	7,70
		P-load	1,28	1,94	$0,48 * ((1,76*(42,9+b))/e)$ or $0,48 * ((14,25*(3+b))/e)$	3,42
		L-load	1,49	2,27	$0,56 * ((1,76*(42,9+b))/e)$ or $0,56 * ((14,25*(3+b))/e)$	3,99
		M-load	1,70	2,59	$0,64 * ((1,76*(42,9+b))/e)$ or $0,64 * ((14,25*(3+b))/e)$	4,56
		S-load	1,92	2,92	$0,72 * ((1,76*(42,9+b))/e)$ or $0,72 * ((14,25*(3+b))/e)$	5,13
		I-load	2,34	3,56	$0,88 * ((1,76*(42,9+b))/e)$ or $0,88 * ((14,25*(3+b))/e)$	6,27