

# SDK2, PDK2 Sealing Caps for Cladding Fastening

## Product data

### Dimensions

#### SDK2 sealing cap

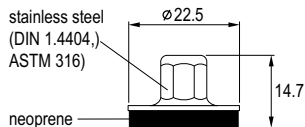

#### PDK2 sealing cap

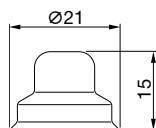

### General information

#### Compatible DX fasteners

X-ENP-19 L15

Base material thickness  $t_{II} \geq 6$  mm

#### Fastening tool

SW/SDK2 setting tool **SDK2**

SW/PDK2 setting tool **PDK2**

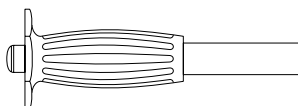

## Applications

### Examples

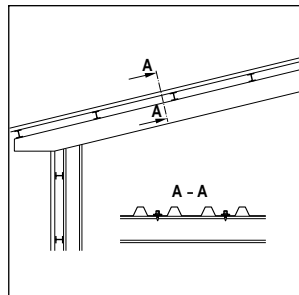

**Roof and wall cladding on single skin buildings**

### SDK2, stainless steel sealing cap for roof and wall cladding

Stainless steel cap not affected by atmospheric corrosion

Space under the cap isolated from the atmosphere

Neoprene washer insulates against contact corrosion and seals the space under the cap-off from the atmosphere

Pressure on the washer seals the gap between the sheet and the base steel

### PDK2, plastic sealing cap for wall cladding

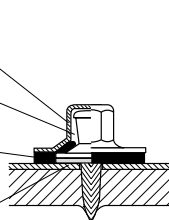

### Corrosion protection

**Fastening quality assurance**

**Fastening inspection**

For detailed information on X-ENP-19 L15 please see the according product pages.

**X-ENP-19 L15**

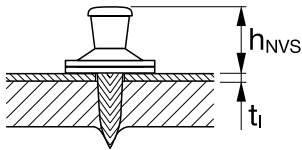

Maximum thickness of single layer (type a):  
 $t_{i, \max} = 1.5 \text{ mm}$   
 Total thickness of end overlap (type c):  
 $\Sigma t_{i, \text{tot}} \leq 2.5 \text{ mm}$

$h_{NVS} = 8.2\text{--}9.8 \text{ mm}$

Note:

It has to be ensured, that the fastened sheet is properly compressed to the base material and no gap remains at fastening point location.

**Installation**

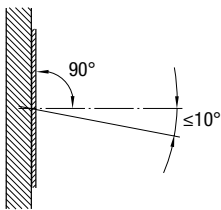

Position the DX tool so that nail inclination is limited to max. 10° from perpendicular to surface

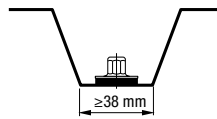
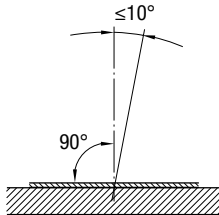

Centre fastening in valley.  
 38 mm min. valley width

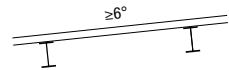

Minimum roof slope 6°

These are abbreviated instructions which may vary by application.

**ALWAYS** review/follow the instructions accompanying the product.