

X-SW 30, X-SW 60 Soft Washer Fastener

Product data

Dimensions

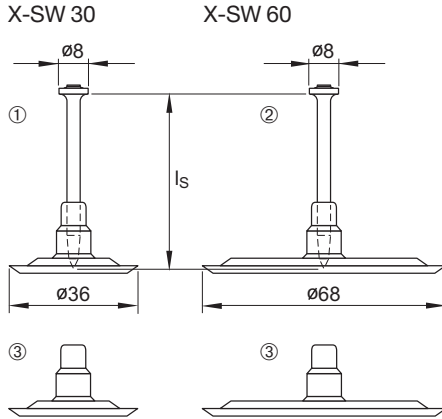

General information

Material specifications

Plate:	PE
Nail:	Carbon steel shank: HRC 52.5
	Zinc coating: 5–13 µm

Recommended fastening tools

DX 460, DX 36, DX-E 72, DX 460-MX

See **X-SW fastener program** in the next pages and **Tools and equipment** chapter for more details.

Applications

Examples

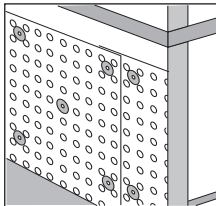

Membranes and drainage plates

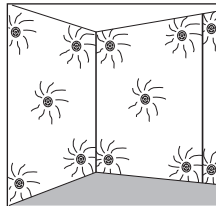

Insulation up to 30 mm thick

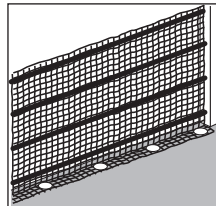

Nets, fabric and similar

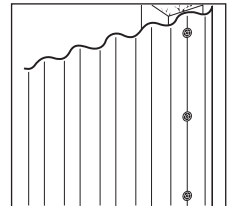

Plastic corrugated sheets

Load data

Recommended loads

$N_{rec} = 300 \text{ N}$

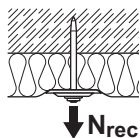

$V_{rec} = 300 \text{ N}$

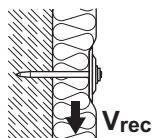

Design conditions:

1. Minimum 5 fastenings per fastened unit.
2. Predominantly static loading.
3. Design loads valid for nail pull-out strength. Fastened material has to be considered separately.
4. Valid for concrete C 30/37.

Application requirements

Thickness of base material

Concrete: $h_{min} = 80 \text{ mm}$

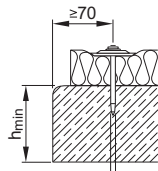

Steel: $t_{II} \geq 4 \text{ mm}$

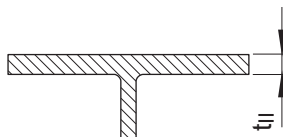

Thickness of fastened material

Membranes, nets, etc.: $t_I \leq 25 \text{ mm}$

Insulation: $t_I \leq 30 \text{ mm}$

Spacing and edge distances

For setting instructions please inquire at the supplier of fastened material.

Fastener selection and system recommendation

Fastening to concrete

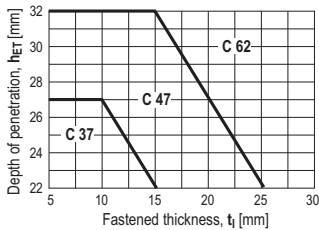

Green concrete

Normal concrete

Old concrete

- **X-SW 30** for stronger, less damageable material.
- **X-SW 60** for more easily damaged material (i.e. aluminium foil, nets, paper, etc.)
- Select **C 37**, **C 47** and **C 62** according to base material conditions and fastened thickness

Fastener program

Designation	Item no.	Packs of 100/150	Packs of 400/500	L_s [mm]	Tools
					Designation
① X-SW 30-C 37	40643		40614	37	DX 460, DX 36, DX-E 72
① X-SW 30-C 47	40644		40615	47	DX 460, DX 36, DX-E 72
① X-SW 30-C 62	40645		40616	62	DX 460, DX 36, DX-E 72
② X-SW 60-C 37	40617			37	DX 460, DX 36, DX-E 72
② X-SW 60-C 47	40618			47	DX 460, DX 36, DX-E 72
② X-SW 60-C 62	40619			62	DX 460, DX 36, DX-E 72
③ X-SW 30	371370				DX 460-MX with collated
③ X-SW 60	371371				X-C nails (3.5 mm shank dia.)

Cartridge selection and tool energy setting

Cartridge recommendation: Concrete **6.8/11M yellow or red**

Masonry: **6.8/11M green**

Tool energy adjustment by setting tests on site.

