

FDV-dokumentasjon

Produkt: 0713122110060 1
3/8" 6-KT.PIPE LANG 10MM

3/8" pipe- og skralleverktøy

3/8" Zebra skralle

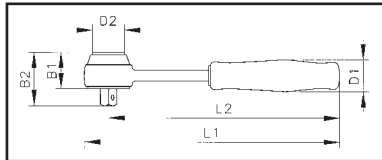

- 72 tenner, 5 grader trekkvinkel

L1 mm	L2 mm	B1 mm	B2 mm	D1 mm	D2 mm	Art. nr.	Pk./stk.
175	160	19	31	26	20	0714 12 151	1

Reparasjonssett for skralle

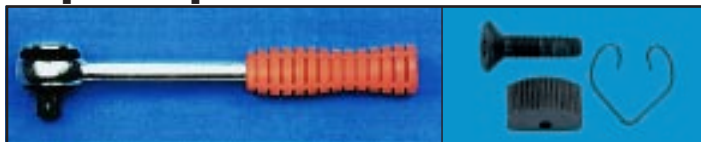

4-kt.	Art. nr.	Type festeskruer	Art. nr.	Pk./stk.
3/8"	0715 12 15	M6 Syl. hode	0715 12 31	1
	0715 12 15	M4 Syl. hode	0715 11 31	
	0714 12 151	M4 Senkhode	0715 11 311	

3/8" Zebra 6-kt. piper - Powerdriv

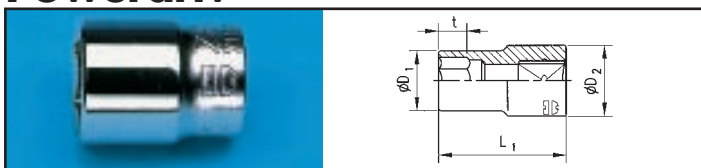

Ø mm	L1 mm	D1 mm	D2 mm	t mm	Art. nr.	Pk./stk.
8	27	12,2	17,7	8	0713 121 108	1
9	27	13,5	17,7	9	0713 121 109	
10	27	14,7	17,7	9	0713 121 110	
11	27	16,0	17,7	10	0713 121 111	
12	27	17,2	17,7	11	0713 121 112	
13	30	18,5	17,7	11	0713 121 113	
14	30	19,7	18,0	13	0713 121 114	
15	30	21,0	19,0	13	0713 121 115	
16	30	22,2	20,0	13	0713 121 116	
17	30	23,5	21,0	13	0713 121 117	
18	33	24,7	21,5	14	0713 121 118	
19	33	26,0	22,5	14	0713 121 119	
20	33	27,2	23,5	14	0713 121 120	
21	33	28,5	25,0	14	0713 121 121	
22	33	29,7	26,0	16	0713 121 122	

3/8" Zebra kardangledd

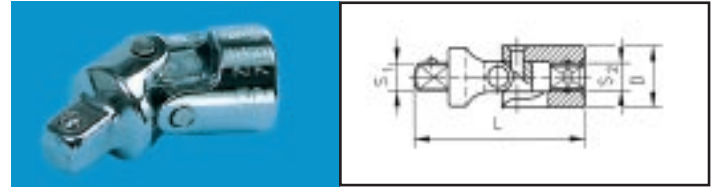

S ₁	S ₂	D mm	L mm	Art. nr.	Pk./stk.
3/8"	3/8"	17,5	55	0713 128 301	1

3/8" Zebra forlengere

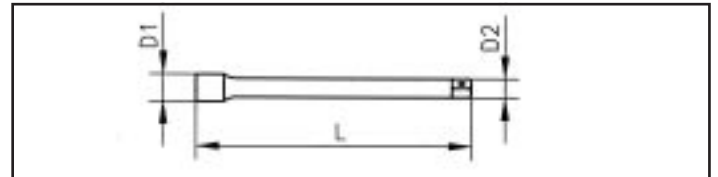

D ₁ mm	D ₂ mm	L mm	Art. nr.	Pk./stk.
17,5	12	75	0713 128 103	1
		125	0713 128 105	
		250	0713 128 110	

3/8" Zebra 6-kt. piper, lange - Powerdriv

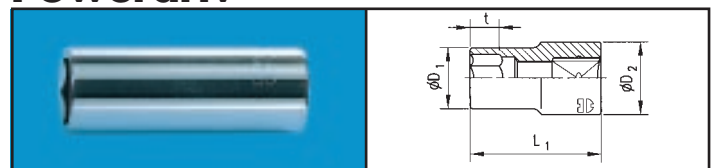

Ø mm	L1 mm	D1 mm	D2 mm	t mm	Art. nr.	Pk./stk.
7	64	10,9	16,7	13	0713 122 107	1
8	64	11,8	16,7	15	0713 122 108	
9	64	13,4	16,7	16	0713 122 109	
10	64	14,6	16,7	25,5	0713 122 110	
11	64	15,9	16,7	25,5	0713 122 111	
12	64	16,7	16,7	25,5	0713 122 112	
13	64	18,2	18,2	25,5	0713 122 113	
14	64	19,5	19,5	25,5	0713 122 114	
15	64	20,7	20,7	25,5	0713 122 115	
16	64	21,7	21,7	25,5	0713 122 116	
17	64	23,3	23,3	25,5	0713 122 117	
18	64	23,8	23,8	25,5	0713 122 118	
19	64	25,4	23,5	25,5	0713 122 119	
21	64	27,8	26	25,5	0713 122 121	
22	64	29,6	27	25,5	0713 122 122	