

Hexagonal bolt with thread up to the head

DIN 933, stainless steel, A4, plain

Standards	DIN 933
Material	Stainless steel A4
Property class	70
Surface	Plain
RoHS-compliant	Yes

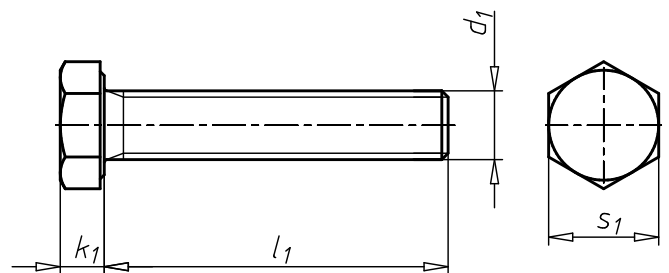

Thread type x nominal diameter (d ₁)	Length (l ₁)	Head height (k ₁)	External drive (s ₁)	Art. no.	P. Qty.
M10	10 mm	6.4 mm	WS17	0091 10 10	100
M10	12 mm	6.4 mm	WS17	0091 10 12	100
M10	14 mm	6.4 mm	WS17	0091 10 14	100
M10	16 mm	6.4 mm	WS17	0091 10 16	100
M10	18 mm	6.4 mm	WS17	0091 10 18	100
M10	20 mm	6.4 mm	WS17	0091 10 20	100
M10	22 mm	6.4 mm	WS17	0091 10 22	100
M10	25 mm	6.4 mm	WS17	0091 10 25	100
M10	30 mm	6.4 mm	WS17	0091 10 30	100
M10	35 mm	6.4 mm	WS17	0091 10 35	100
M10	40 mm	6.4 mm	WS17	0091 10 40	100
M10	45 mm	6.4 mm	WS17	0091 10 45	100
M10	50 mm	6.4 mm	WS17	0091 10 50	100
M10	55 mm	6.4 mm	WS17	0091 10 55	100
M10	60 mm	6.4 mm	WS17	0091 10 60	50/100
M10	65 mm	6.4 mm	WS17	0091 10 65	50/100
M10	70 mm	6.4 mm	WS17	0091 10 70	50
M10	75 mm	6.4 mm	WS17	0091 10 75	50
M10	80 mm	6.4 mm	WS17	0091 10 80	50
M10	85 mm	6.4 mm	WS17	0091 10 85	50
M10	90 mm	6.4 mm	WS17	0091 10 90	50
M10	100 mm	6.4 mm	WS17	0091 10 100	25/50
M10	110 mm	6.4 mm	WS17	0091 10 110	25
M10	120 mm	6.4 mm	WS17	0091 10 120	25
M10	130 mm	6.4 mm	WS17	0091 10 130	25/50
M10	140 mm	6.4 mm	WS17	0091 10 140	25/50
M10	150 mm	6.4 mm	WS17	0091 10 150	25
M10	160 mm	6.4 mm	WS17	0091 10 160	25
M10	170 mm	6.4 mm	WS17	0091 10 170	25

Thread type x nominal diameter (d ₁)	Length (l ₁)	Head height (k ₁)	External drive (s ₁)	Art. no.	P. Qty.
M10	180 mm	6.4 mm	WS17	0091 10 180	25/50
M10	190 mm	6.4 mm	WS17	0091 10 190	25
M10	200 mm	6.4 mm	WS17	0091 10 200	50
M10	210 mm	6.4 mm	WS17	0091 10 210	10
M12	12 mm	7.5 mm	WS19	0091 12 12	100
M12	16 mm	7.5 mm	WS19	0091 12 16	100
M12	18 mm	7.5 mm	WS19	0091 12 18	100
M12	20 mm	7.5 mm	WS19	0091 12 20	50/100
M12	25 mm	7.5 mm	WS19	0091 12 25	50
M12	30 mm	7.5 mm	WS19	0091 12 30	50
M12	35 mm	7.5 mm	WS19	0091 12 35	50
M12	40 mm	7.5 mm	WS19	0091 12 40	50
M12	45 mm	7.5 mm	WS19	0091 12 45	50
M12	50 mm	7.5 mm	WS19	0091 12 50	50
M12	55 mm	7.5 mm	WS19	0091 12 55	50
M12	60 mm	7.5 mm	WS19	0091 12 60	50
M12	65 mm	7.5 mm	WS19	0091 12 65	50
M12	70 mm	7.5 mm	WS19	0091 12 70	25/50
M12	75 mm	7.5 mm	WS19	0091 12 75	25/50
M12	80 mm	7.5 mm	WS19	0091 12 80	25
M12	85 mm	7.5 mm	WS19	0091 12 85	50
M12	90 mm	7.5 mm	WS19	0091 12 90	25
M12	95 mm	7.5 mm	WS19	0091 12 95	50
M12	100 mm	7.5 mm	WS19	0091 12 100	25
M12	110 mm	7.5 mm	WS19	0091 12 110	25/50
M12	120 mm	7.5 mm	WS19	0091 12 120	25/50
M12	130 mm	7.5 mm	WS19	0091 12 130	25
M12	140 mm	7.5 mm	WS19	0091 12 140	25
M12	150 mm	7.5 mm	WS19	0091 12 150	25/50
M12	160 mm	7.5 mm	WS19	0091 12 160	10
M12	170 mm	7.5 mm	WS19	0091 12 170	10
M12	180 mm	7.5 mm	WS19	0091 12 180	10
M12	190 mm	7.5 mm	WS19	0091 12 190	10
M12	200 mm	7.5 mm	WS19	0091 12 200	10/50
M14	20 mm	8.8 mm	WS22	0091 14 20	25
M14	25 mm	8.8 mm	WS22	0091 14 25	50
M14	30 mm	8.8 mm	WS22	0091 14 30	50
M14	35 mm	8.8 mm	WS22	0091 14 35	25
M14	40 mm	8.8 mm	WS22	0091 14 40	50
M14	45 mm	8.8 mm	WS22	0091 14 45	50
M14	50 mm	8.8 mm	WS22	0091 14 50	25/50
M14	55 mm	8.8 mm	WS22	0091 14 55	50
M14	60 mm	8.8 mm	WS22	0091 14 60	25
M14	65 mm	8.8 mm	WS22	0091 14 65	25
M14	70 mm	8.8 mm	WS22	0091 14 70	25/50
M14	80 mm	8.8 mm	WS22	0091 14 80	25/50
M14	90 mm	8.8 mm	WS22	0091 14 90	25
M14	100 mm	8.8 mm	WS22	0091 14 100	25
M14	110 mm	8.8 mm	WS22	0091 14 110	25/50
M14	120 mm	8.8 mm	WS22	0091 14 120	25
M14	140 mm	8.8 mm	WS22	0091 14 140	25
M14	150 mm	8.8 mm	WS22	0091 14 150	25
M14	160 mm	8.62 mm	WS22	0091 14 160	100
M22	50 mm	14 mm	WS32	0091 22 50	25

Thread type x nominal diameter (d ₁)	Length (l ₁)	Head height (k ₁)	External drive (s ₁)	Art. no.	P. Qty.
M22	60 mm	14 mm	WS32	0091 22 60	25
M22	65 mm	14 mm	WS32	0091 22 65	25
M22	70 mm	14 mm	WS32	0091 22 70	25
M22	80 mm	14 mm	WS32	0091 22 80	25
M22	90 mm	14 mm	WS32	0091 22 90	25
M22	100 mm	14 mm	WS32	0091 22 100	5
M22	110 mm	14 mm	WS32	0091 22 110	10

Notice

DIN 933 has been withdrawn and replaced by ISO 4017. There is some similarity (nominal dimensions extended | Width across flats changed for M10, M12, M14 and M22).