

FDV-dokumentasjon

Produkt: 0712130101060 1

1/2" LATMANN LEDDHÅNDTAK
L:370MM

1/2" pipe- og skralleverktøy

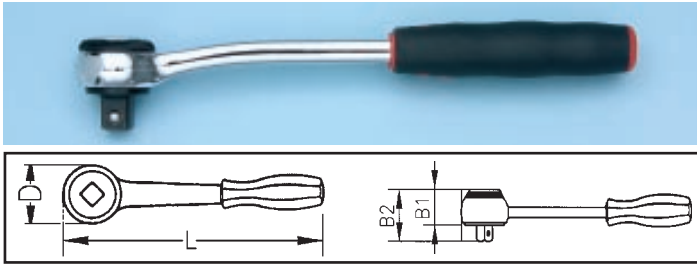

1/2" Skralle

D mm	L mm	B1 mm	B2 mm	Art. nr.	Pk./stk.
39	250	26	41	0712 012	1

Reparasjonssett for skralle



4-kt.	Art. nr.	Type festeskruve	Art. nr.	Pk./stk.
1/2"	0712 012	M6 sylinderhode	0715 12 31	1
	0712 012	M6 senkhode	0715 12 32	

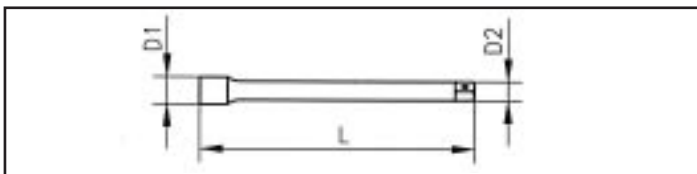

1/2" Zebra forlengere

D1 mm	D2 mm	L mm	Art. nr.	Pk./stk.
23	15	125	0712 138 105	1
23	15	250	0712 138 110	

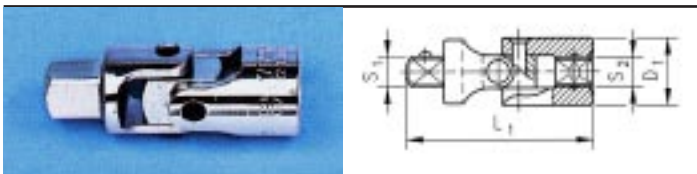

1/2" Zebra kardangledd

S1 mm	S2 mm	D1 mm	L1 mm	Art. nr.	Pk./stk.
1/2"	1/2"	25	70	0712 138 301	1



1/2" Zebra overgang

S1 mm	S2 mm	D1 mm	L1 mm	Art. nr.	Pk./stk.
3/8"	1/2"	23	38	0712 138 401	1
3/4"	1/2"	25	44	0712 138 402	

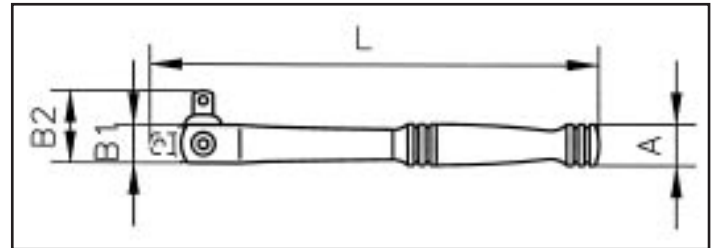

L mm	B1 mm	B2 mm	A mm	Art. nr.	Pk./stk.
370	20	37	35	0712 130 101	1
496	20	37	35	0712 130 102	

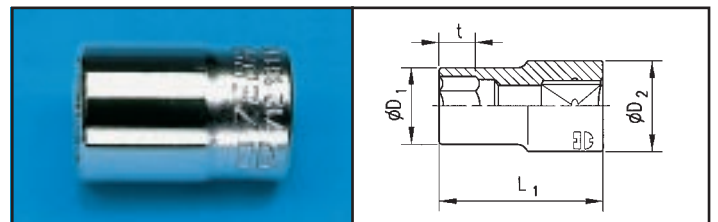

1/2" Zebra 6-kt. piper - Powerdriv

NV	L1 mm	D1 mm	D2 mm	t mm	Art. nr.	Pk./stk.
8	36	13	23	8	0712 131 108	1
9	36	14,2	23	9	0712 131 109	
10	36	15,5	23	9	0712 131 110	
11	36	16,7	23	10	0712 131 111	
12	36	18	23	11	0712 131 112	
13	36	19,2	23	11	0712 131 113	
14	36	20,5	23	13	0712 131 114	
15	36	21,7	22	13	0712 131 115	
16	36	23	23,2	13	0712 131 116	
17	36	24,2	23,2	13	0712 131 117	
18	36	25,5	23,5	14	0712 131 118	
19	36	26,7	24,7	14	0712 131 119	
20	36	28	25,5	14	0712 131 120	
21	36	29,2	26	14	0712 131 121	
22	38	30,5	26,5	16	0712 131 122	
23	38	31,7	27,7	16	0712 131 123	
24	38	33	29	18	0712 131 124	
26	38	35,5	31,5	18	0712 131 126	
27	44	36,7	32,2	20	0712 131 127	
28	44	38	33,5	20	0712 131 128	
30	44	40,5	36	22	0712 131 130	
32	44	43	38,1	24	0712 131 132	
34	47	45,5	40	25	0712 131 134	