

# FDV-dokumentasjon

Produkt: 0712131123090 1  
1/2" 6-KT.PIPE 23MM

# 1/2" pipe- og skralleverktøy

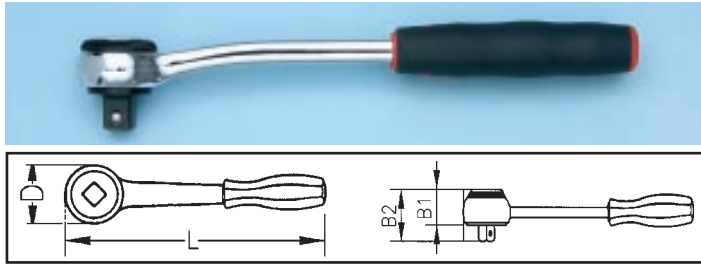

## 1/2" Skralle

D mm	L mm	B1 mm	B2 mm	Art. nr.	Pk./stk.
39	250	26	41	<b>0712 012</b>	1

## Reparasjonssett for skralle



4-kt.	Art. nr.	Type festeskruue	Art. nr.	Pk./stk.
1/2"	<b>0712 012</b>	M6 sylindrhode	<b>0715 12 31</b>	1
	<b>0712 012</b>	M6 senkhode	<b>0715 12 32</b>	

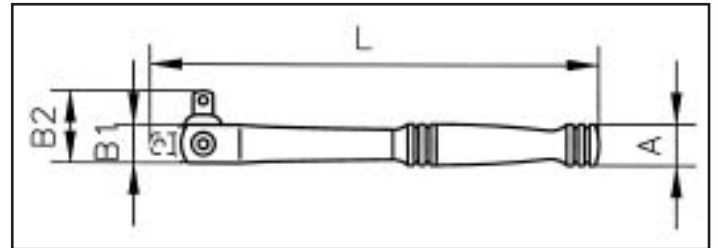

L mm	B1 mm	B2 mm	A mm	Art. nr.	Pk./stk.
370	20	37	35	<b>0712 130 101</b>	1
496	20	37	35	<b>0712 130 102</b>	

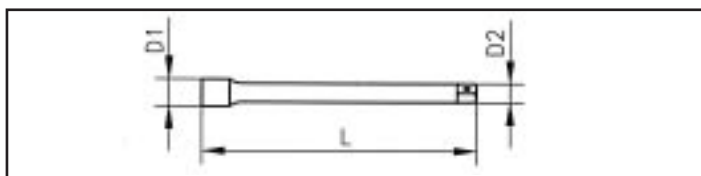

## 1/2" Zebra forlengere

D1 mm	D2 mm	L mm	Art. nr.	Pk./stk.
23	15	125	<b>0712 138 105</b>	1
23	15	250	<b>0712 138 110</b>	

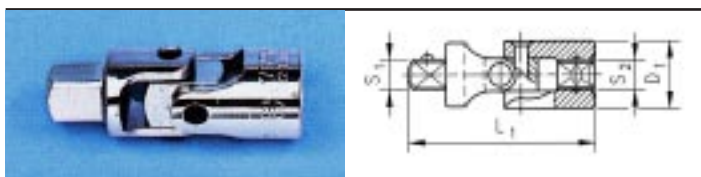

## 1/2" Zebra kardangledd

S1 mm	S2 mm	D1 mm	L1 mm	Art. nr.	Pk./stk.
1/2"	1/2"	25	70	<b>0712 138 301</b>	1



## 1/2" Zebra overgang

S1 mm	S2 mm	D1 mm	L1 mm	Art. nr.	Pk./stk.
3/8"	1/2"	23	38	<b>0712 138 401</b>	1
3/4"	1/2"	25	44	<b>0712 138 402</b>	

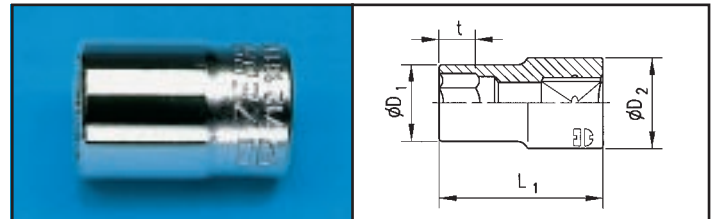

## 1/2" Zebra 6-kt. piper - Powerdriv

NV	L1 mm	D1 mm	D2 mm	t mm	Art. nr.	Pk./stk.
8	36	13	23	8	<b>0712 131 108</b>	1
9	36	14,2	23	9	<b>0712 131 109</b>	
10	36	15,5	23	9	<b>0712 131 110</b>	
11	36	16,7	23	10	<b>0712 131 111</b>	
12	36	18	23	11	<b>0712 131 112</b>	
13	36	19,2	23	11	<b>0712 131 113</b>	
14	36	20,5	23	13	<b>0712 131 114</b>	
15	36	21,7	22	13	<b>0712 131 115</b>	
16	36	23	23,2	13	<b>0712 131 116</b>	
17	36	24,2	23,2	13	<b>0712 131 117</b>	
18	36	25,5	23,5	14	<b>0712 131 118</b>	
19	36	26,7	24,7	14	<b>0712 131 119</b>	
20	36	28	25,5	14	<b>0712 131 120</b>	
21	36	29,2	26	14	<b>0712 131 121</b>	
22	38	30,5	26,5	16	<b>0712 131 122</b>	
23	38	31,7	27,7	16	<b>0712 131 123</b>	
24	38	33	29	18	<b>0712 131 124</b>	
26	38	35,5	31,5	18	<b>0712 131 126</b>	
27	44	36,7	32,2	20	<b>0712 131 127</b>	
28	44	38	33,5	20	<b>0712 131 128</b>	
30	44	40,5	36	22	<b>0712 131 130</b>	
32	44	43	38,1	24	<b>0712 131 132</b>	
34	47	45,5	40	25	<b>0712 131 134</b>	