

### Climbing cone 15/M24

Provides a suspension point for the climbing scaffold. Serves as a positioning and climbing cone. Load capacity depends on ties and concrete quality. Suited for anchor plates 15/120 and 15/170.

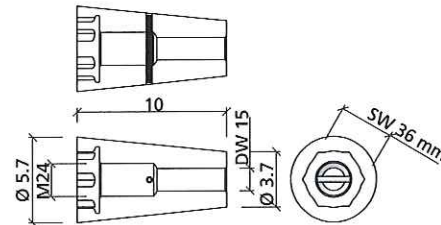

Ref. No.	Description / Application	m <sup>2</sup>	kg
29-412-70	..... Climbing cone 15/M24		1.0



### Climbing cone 20/M24

Yellow chromated. Provides a suspension point for the climbing scaffold. Serves as a positioning and climbing cone. Load capacity depends on ties and concrete quality. Suited for anchor plate 20/170.

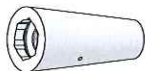

Ref. No.	Description / Application	m <sup>2</sup>	kg
29-412-75	..... Climbing cone 20/M24		1.3

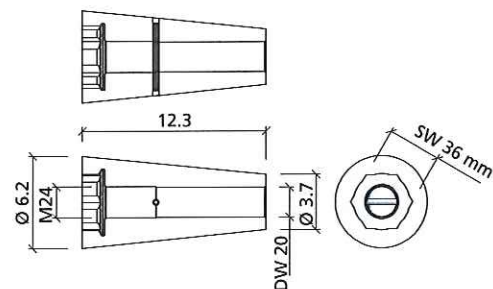

### Conical sleeve

Suited for climbing cone 15/M24. Is slipped over the climbing cone before pouring and this way eases removing the climbing cone from the set concrete.

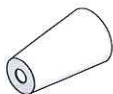

Ref. No.	Description / Application	m <sup>2</sup>	kg
29-412-95	..... Conical sleeve		

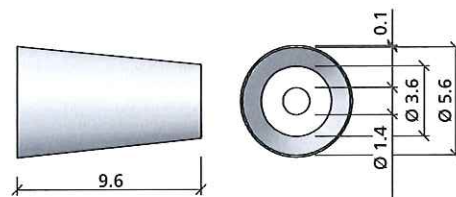

### Positioning disc M24

Galvanized. Is used to attach the climbing cone to the facing (4 drill holes with Ø 5 mm). The anchor plate must be secured additionally, e.g. by wiring it to the rebars.

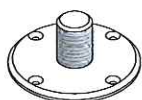

Ref. No.	Description / Application	m <sup>2</sup>	kg
29-412-85	..... Positioning disc M24		0.3

