

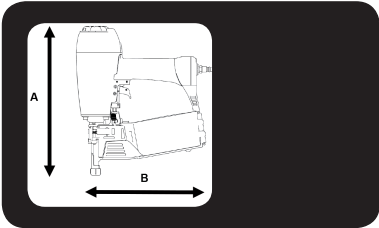

Paslode[®]

CNP50.1





		<p>A = 305 mm B = 310 mm C = 146 mm</p>
		<p>= 2,1 kg</p>

<p>Min. 5,5 bar Max 8,3 bar</p>
<p>1,28l (6 bar) / </p>
<p>Ps max. = 8,3 bar</p>

<p>EN 12549+EN ISO 4871</p>	<p>L WA.1s = 95 dBA L pA.1s = 92 dBA L pA.1s1m = 82 dBA</p>
<p>EN12096 : 1997</p> <p>ISO 8662-11</p>	<p>Vibration = 2,5 m/s²</p>

<p>325 x = </p>
<p>Paslode 0° Coil Nails</p>

<p>Paslode IN-tape</p>

<p>D max.= 5,8 mm L = 27-50 mm d = 2,1- 2,8mm</p>





+









=





	<p>Sequential trigger actuation/ Einzelauslösung/ enkelschots/ Déclenchement du tir - mode séquentiel/ Funcionamiento secuencial "en continuo"/ Gatilho de actuação sequencial/ funzionamento sequenziale (colpo a colpo)/ Enkeltskuds aftrækker/ Enkelskott/ Enkeltskudds avtrekker/ Kertalaukaisu/ Üksiklasu meetodil töötamine/ Uruchromienie spustu sekwencyjne/ Sekvenčni spoušt/ Egyes lövés (szakaszosan működtetett elsütő billentyűvel)/ Posamezno proženje/ Kontaktirajte singli / Последовательная активация при нажатии на курок/ Sekvenčná aktivácia spúšte/ التشغيل بالزر التسلسلي) / Kontaktinis paleidimo mechanizmas/ Sekvenciālās palaišanas iedarbināšana Raðkveikjuvirkjun</p>
	<p>Contact trigger actuation/ Kontaktauslösung/ repeterend schieten/ Déclenchement du tir - mode rafale/ Funcionamiento por contacto "clavo a clavo"/ Gatilho de actuação por contacto/ funcionamiento a contacto/ Stødskydnings aftrækker/ Støtskjutning/ Støtspikrings avtrekker/ Kosketuslaukaisu/ Automaatmeetodil töötamine/ Uruchromienie spustu przez kontakt/ Kontaktní spoušt/ Sorozatlövés (folyamatosan behúzott elsütő billentyűvel)/ Kontaktno proženje/ Kontaktirajte pokretanje/ Контактная активация при нажатии на курок/ Kontaktná aktivácia spúšte/ التشغيل بتلامس الزر / Kontaktinis paleidimo mechanizmas/ Kontakta palaišanas iedarbināšana/ Snertikveikjuvirkjun</p>

<p>Model: CNP50.1 No. 575186</p>  	<p>Model: CNP50.1 No. 575172</p>  
  <p>No. 575641</p>	

		 <p>No. 617062</p>	 <p>No. 014121</p>		 <p>3x</p>
<p>No. 014748 + No. 576673</p>		<p>No. 617062</p>	<p>No. 014121</p>		

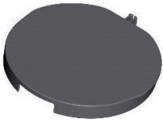
Accessories

		
<p>No. 576487</p>	<p>No. 505203</p>	<p>No. 151299 / No. 576216</p>
<p>Hanger</p>	<p>Magazine insert</p>	<p>0,5 l oil / 1 l oil</p>



014 748

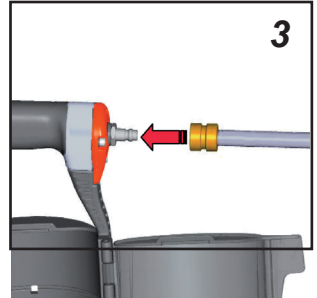
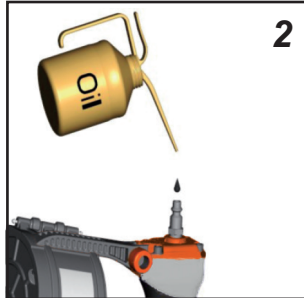
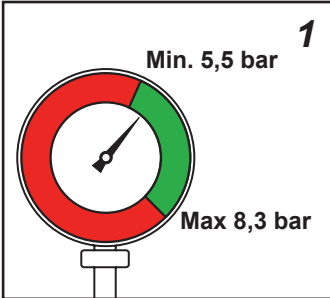

$L < 35 \text{ mm}$

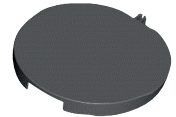



014 748

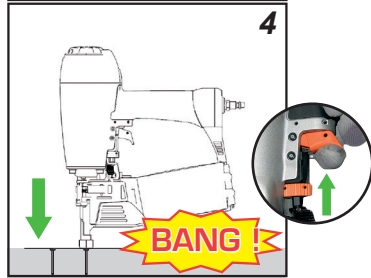
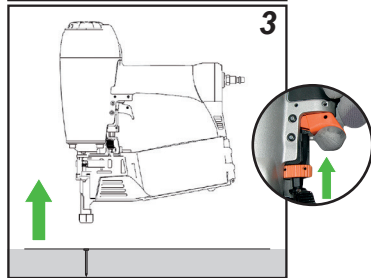
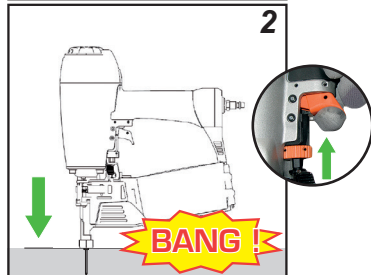
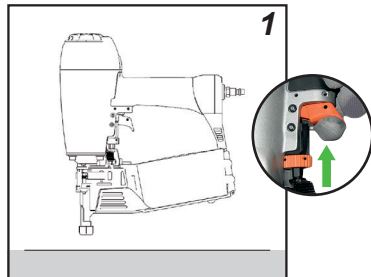
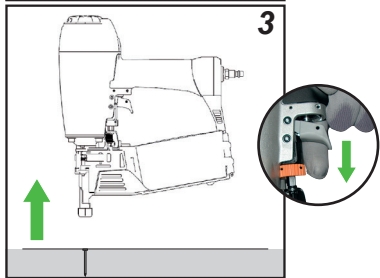
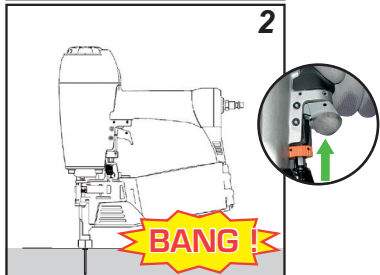
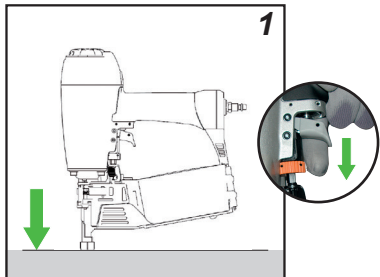

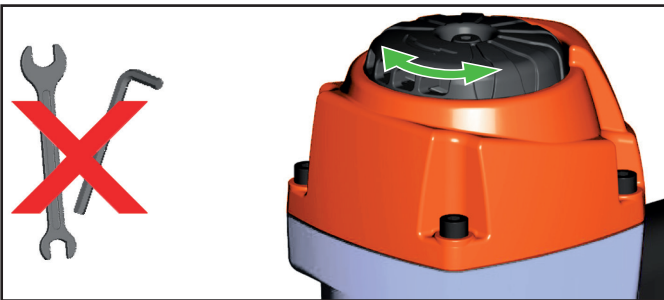
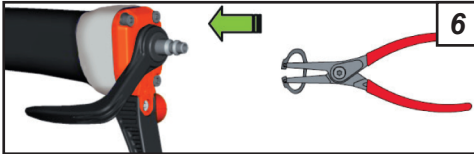
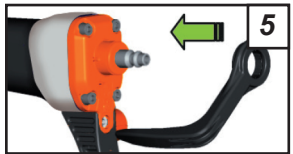
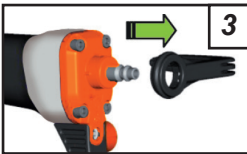
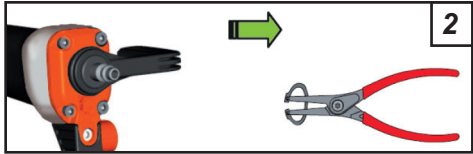
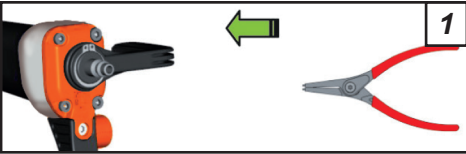
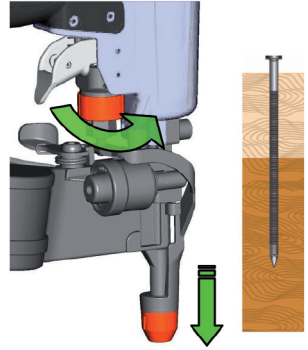
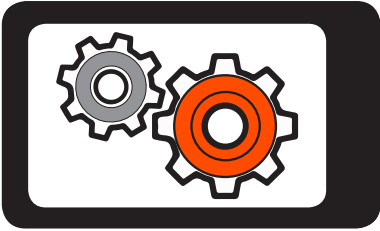

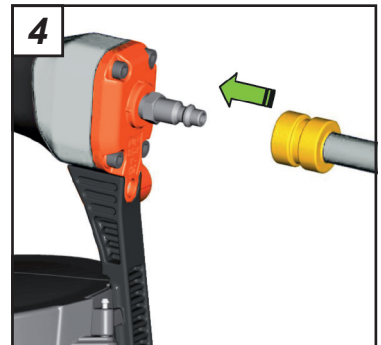
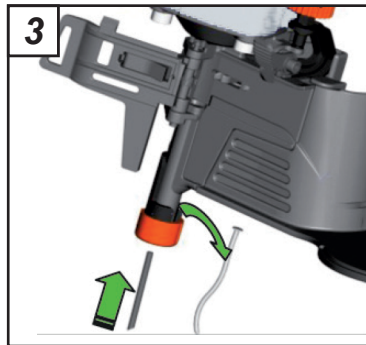
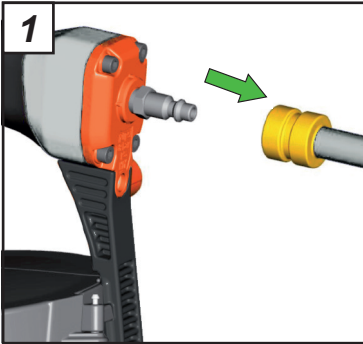
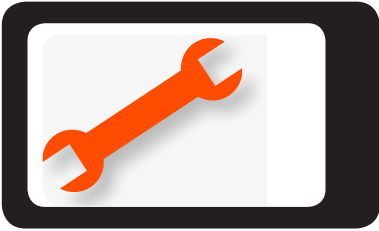

YY/WW....



YY= Year of manufacture
WW = Week of manufacture

**Resting position/ Ruheposition/ Position de repos/ Ruststand/
Posición de descanso/ Posizione di riposo/ Posição de des-
canso/ Pozycja spoczynku/ Klidová poloha/ Nyugalmi állapot/
Положение в нерабочем состоянии/ Θέση αδράνειας/ Hvile-
tilling/ Viloläge/ Hvileposisjon/ Lepoasento/ Položaj mirovanja/
Pokožová poloha/ Položaj mirovanja/ وضع السكون / Ramybės
padėtis/ Ooteasend/ Miera stāvoklis/ Hvíldarstaða**





ITW CONSTRUCTION PRODUCTS EUROPE
Code 576673 (04/2019)
www.spitpaslode.com