

## Surface spacers

## Surface spacers

Depending on the application, surface spacers could be an alternative to single spacers, because of shorter installation time and the associated savings in labour costs. Thereby should be placed high attention to install the surface spacers not in a line, to avoid large linear grooves in the concrete body.

Generally, like for single spacer, the following criteria apply:

- Number of surface spacers per m<sup>2</sup> depending on the concentration and deflection of the reinforcement
- Mounting on the reinforcement and stability vis-à-vis the formwork
- Quality of surface spacer
- With very heavy reinforcement, the number of surface spacers may have to be increased significantly
- Any loads caused by staff working on the reinforcement or additional loads from upper reinforcement that are transferred to the lower reinforcement via steel frames have to be supported by additional spacers in this area.

In our complete range of surface spacer a reinforcing wire is imbedded. This galvanized reinforcing wire avoids also with high exposures a break apart and secures therefore the required concrete cover. On the ends this wire is V-shaped bent off. Hereby the tensile strength increases and a break apart is nearly impossible. Essential is, that the surface spacer is placed in his position fixed and that the spacer doesn't get damages through the occurring forces until the concrete is installed.

On request we are able deliver all our spacer also as fiber concrete spacers.

## Triangular surface spacer



- High stability through wide support surface
- Concrete cover = wide support surface
- Applicable also for isolations
- High bearing pressure

## Triangular surface spacer



- High stability through wide support surface
- Concrete cover = wide support surface
- Applicable also for isolations
- High bearing pressure

## Triangular surface spacer



- High stability through wide support surface
- Concrete cover = wide support surface
- Applicable also for isolations
- High bearing pressure

## Triangular surface spacer



- High stability through wide support surface
- Concrete cover = wide support surface
- Applicable also for isolations
- High bearing pressure

L = appr. 1200 mm

Article Nr.	Height mm	Palette Pieces	Palette kg
2900/30/1200/BD/StQ1	30	600	946
2901/35/1200/BD/StQ1	35	500	1052
2902/40/1200/BD/StQ1	40	400	1035
2903/45/1200/BD/StQ1	45	300	970
2904/50/1200/BD/StQ1	50	300	1137
2905/55/1200/BD/StQ1	55	250	1100
2906/60/1200/BD/StQ1	60	200	1025
2908/70/1200/BD/StQ1	70	150	1045

L = appr. 600 mm

Article Nr.	Height mm	Palette Pieces	Palette kg
2920/30/600/BD/StQ1	30	1200	946
2921/35/600/BD/StQ1	35	1000	1052
2922/40/600/BD/StQ1	40	800	1035
2923/45/600/BD/StQ1	45	600	970
2924/50/600/BD/StQ1	50	600	1137
2925/55/600/BD/StQ1	55	500	1100
2926/60/600/BD/StQ1	60	400	1025
2928/70/600/BD/StQ1	70	300	1045

L = appr. 300 mm

Article Nr.	Height mm	Palette Pieces	Palette kg
2960/30/300/BD/StQ1	30	2400	946
2961/35/300/BD/StQ1	35	2000	1052
2962/40/300/BD/StQ1	40	1600	1035
2963/45/300/BD/StQ1	45	1200	970
2964/50/300/BD/StQ1	50	1200	1137
2965/55/300/BD/StQ1	55	1000	1100
2966/60/300/BD/StQ1	60	800	1025
2968/70/300/BD/StQ1	70	600	1045

L = appr. 200 mm

Article Nr.	Height mm	Palette Pieces	Palette kg
2980/30/200/BD/StQ1	30	3600	946
2981/35/200/BD/StQ1	35	3000	1052
2982/40/200/BD/StQ1	40	2400	1035
2983/45/200/BD/StQ1	45	1800	970
2984/50/200/BD/StQ1	50	1800	1137
2985/55/200/BD/StQ1	55	1500	1100
2986/60/200/BD/StQ1	60	1200	1025
2988/70/200/BD/StQ1	70	900	1045

## Surface spacers

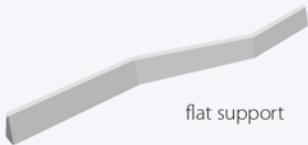
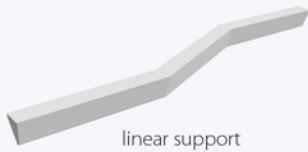
Trapezium-shaped surface spacer  
"ZickZack"

- Length 800mm for horizontal reinforcement
- Inserted galvanized reinforcement wire with end anchorage
- High tensile strength
- Can be used on both sides
- Round, linear support surface to meet exposed concrete requirements
- Wide flat support surface for soft shuttering backing surfaces, e.g. insulation
- Very stable for high load assumption
- In each position guaranteed safety of the concrete covering

L = appr. 800 mm

Article Nr.	Height mm	Palette Pieces	Palette kg
7000/20/800/BD/StQ1	20	1500	997
7001/25/800/BD/StQ1	25	1200	997
7002/30/800/BD/StQ1	30	750	925
7003/35/800/BD/StQ1	35	700	998
7004/40/800/BD/StQ1	40	500	839
7005/45/800/BD/StQ1	45	500	1000
7006/50/800/BD/StQ1	50	400	886
7007/55/800/BD/StQ1	55	400	977
7008/60/800/BD/StQ1	60	320	995
7010/70/800/BD/StQ1	70	250	870
7011/75/800/BD/StQ1	75	225	900
7012/80/800/BD/StQ1	80	200	900
7014/90/800/BD/StQ1	90	150	850
7016/100/800/BD/StQ1	100	120	900

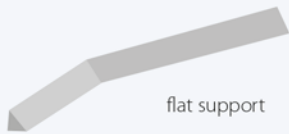
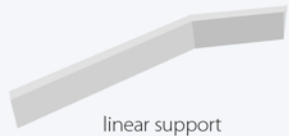
Trapezium-shaped surface spacer  
"Zack"

- Length 400 mm for horizontal reinforcement
- Secured against tilting through lengthwise buckle
- Two-sided applicable
- High bearing pressure

L = appr. 400 mm

Article Nr.	Height mm	Palette Pieces	Palette kg
7030/20/400/BD/StQ1	20	3000	997
7031/25/400/BD/StQ1	25	2400	997
7032/30/400/BD/StQ1	30	1500	925
7033/35/400/BD/StQ1	35	1400	998
7034/40/400/BD/StQ1	40	1000	839
7035/45/400/BD/StQ1	45	1000	1000
7036/50/400/BD/StQ1	50	800	886
7037/55/400/BD/StQ1	55	800	977
7038/60/400/BD/StQ1	60	640	995
7039/70/400/BD/StQ1	70	500	870
7040/75/400/BD/StQ1	75	450	900
7041/80/400/BD/StQ1	80	400	900
7043/90/400/BD/StQ1	90	300	850

High bearing pressure Trapezium-shaped surface spacer  
"Bumerang"

- Length 340 mm for horizontal reinforcement
- Two-sided applicable
- Round, lined support surface applicable for exposed concrete
- Flat and wide support surface for flexible and soft underground like isolations
- 100 % stability through kinked longitudinal profile
- Very stable for high bearing pressure

L = appr. 340 mm

Article Nr.	Height mm	Palette Pieces	Palette kg
6001/30/340/BD/StQ1	30	2000	986
6003/40/340/BD/StQ1	40	1400	993
6004/50/340/BD/StQ1	50	1000	830

## Trapezium-shaped surface spacer



- Length 670 mm with burlings for horizontal reinforcement
- With galvanized reinforcement insert with end anchorage
- Small contact surfaces with the formwork through point-shaped support surface
- Suitable for exposed concrete
- Safe against tilting through kink in longitudinal direction

L = appr. 680 mm

Article Nr.	Height mm	Palette Pieces	Palette kg
3000/25/680/BD/StQ1	25	1150	768
3001/30/680/BD/StQ1	30	1100	906
3002/35/680/BD/StQ1	35	850	834
3003/40/680/BD/StQ1	40	800	946
3004/45/680/BD/StQ1	45	750	1001
3005/50/680/BD/StQ1	50	700	1041
3006/55/680/BD/StQ1	55	500	946
3007/60/680/BD/StQ1	60	400	843
3008/65/680/BD/StQ1	65	350	828
3009/70/680/BD/StQ1	70	320	816
3010/75/680/BD/StQ1	75	280	815
3011/80/680/BD/StQ1	80	250	810

Surface spacers

Trapezium-shaped surface spacer with galvanized spring steel clip

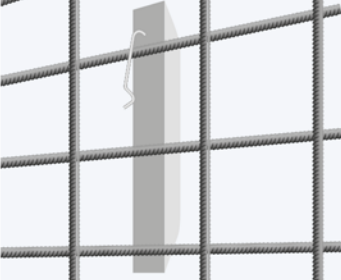

- Length of app. 200 mm with spring steel clip for vertical reinforcement

Article Nr.	Height mm	Palette Pieces	Palette kg
2021/25/200/BD/FK1/StQ1	25	3000	697
2022/30/200/BD/FK1/StQ1	30	2500	702
2023/35/200/BD/FK1/StQ1	35	2000	697
2024/40/200/BD/FK1/StQ1	40	1800	702
2026/50/200/BD/FK1/StQ1	50	1200	700

L = appr. 200 mm

Trapezium-shaped surface spacer with galvanized wires

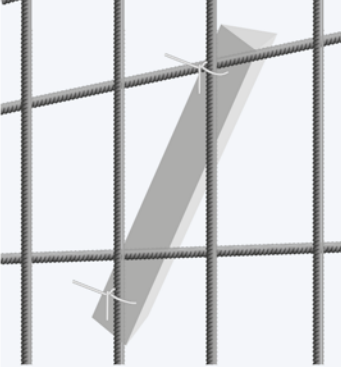

- Length app. 300 mm and 200 mm for vertical applications
- Rounded support surface against the form work
- Line shaped formwork contact
- Big bearing stance on the reinforcement
- Concrete cover = bearing stance
- 4 pieces of fixing wires

Article Nr.	Height mm	Palette Pieces	Palette kg
4010/30/300/BD/DR1.2/4/180/StQ1	30	2400	965
4011/35/300/BD/DR1.2/4/180/StQ1	35	2000	1068
4012/40/300/BD/DR1.2/4/180/StQ1	40	1600	1047
4013/45/300/BD/DR1.2/4/180/StQ1	45	1200	979
4014/50/300/BD/DR1.2/4/180/StQ1	50	1200	1144
4015/55/300/BD/DR1.2/4/180/StQ1	55	1000	1108
4016/60/300/BD/DR1.2/4/180/StQ1	60	850	1031
4018/70/300/BD/DR1.2/4/180/StQ1	70	650	1050

L = appr. 300 mm

Trapezium-shaped surface spacer with galvanized wires

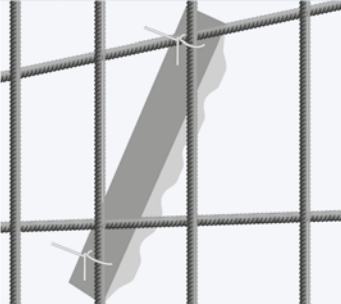

- Length of 300 mm with burlings and large recesses for vertical reinforcement
- Small contact surface to the formwork
- 4 pieces of fixing wires

Article Nr.	Height mm	Palette Pieces	Palette kg
4050/30/200/BD/DR1.2/4/180/StQ1	30	3600	974
4051/35/200/BD/DR1.2/4/180/StQ1	35	3000	1049
4052/40/200/BD/DR1.2/4/180/StQ1	40	2400	1054
4053/45/200/BD/DR1.2/4/180/StQ1	45	1800	984
4054/50/200/BD/DR1.2/4/180/StQ1	50	1800	1049
4055/55/200/BD/DR1.2/4/180/StQ1	55	1500	1112
4056/60/200/BD/DR1.2/4/180/StQ1	60	1200	1034
4058/70/200/BD/DR1.2/4/180/StQ1	70	900	1052

L = appr. 200 mm

Trapezium-shaped surface spacer with spring steel clip

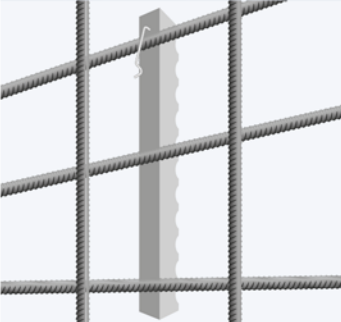

- Length app. 340 mm with burlings for vertical reinforcement
- 1 spring steel clip
- Small contact surface to the formwork as a result of the point shaped support surface
- Applicable for exposed concrete

Article Nr.	Height mm	Palette Pieces	Palette kg
4000/40/300/BD/DR1.2/4/180/StQ1	40	2000	1000
4002/50/300/BD/DR1.2/4/180/StQ1	50	1560	1227
4004/60/300/BD/DR1.2/4/180/StQ1	60	1120	1146
4006/70/300/BD/DR1.2/4/180/StQ1	70	1000	1336
4008/80/300/BD/DR1.2/4/180/StQ1	80	800	1354

L = appr. 300 mm

Trapezium-shaped surface spacer with spring steel clip

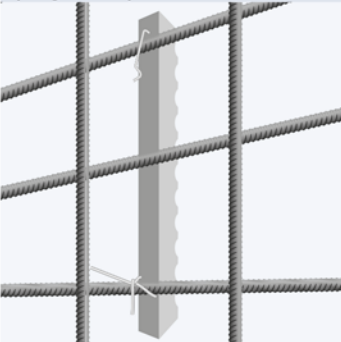

- Length app. 340 mm with burlings for vertical reinforcement
- 1 spring steel clip and 2 fixing wires
- Small contact surface to the formwork as a result of the point shaped support surface
- Applicable for exposed concrete

Article Nr.	Height mm	Palette Pieces	Palette kg
3020/25/340/BD/FK1/StQ1	25	2400	779
3021/30/340/BD/FK1/StQ1	30	1800	751
3022/35/340/BD/FK1/StQ1	35	1600	790
3023/40/340/BD/FK1/StQ1	40	1300	777
3024/45/340/BD/FK1/StQ1	45	1200	809
3025/50/340/BD/FK1/StQ1	50	1100	826
3026/55/340/BD/FK1/StQ1	55	1000	918
3027/60/340/BD/FK1/StQ1	60	800	845
3028/65/340/BD/FK1/StQ1	65	700	829
3029/70/340/BD/FK1/StQ1	70	640	817
3030/75/340/BD/FK1/StQ1	75	560	816
3031/80/340/BD/FK1/StQ1	80	500	811
3040/25/340/BD/FK1DR1.2/2/180/StQ1	25	2400	779
3041/30/340/BD/FK1DR1.2/2/180/StQ1	30	1800	751
3042/35/340/BD/FK1DR1.2/2/180/StQ1	35	1600	790
3043/40/340/BD/FK1DR1.2/2/180/StQ1	40	1300	777
3044/45/340/BD/FK1DR1.2/2/180/StQ1	45	1200	809
3045/50/340/BD/FK1DR1.2/2/180/StQ1	50	1100	826
3046/55/340/BD/FK1DR1.2/2/180/StQ1	55	1000	918
3047/60/340/BD/FK1DR1.2/2/180/StQ1	60	800	845
3048/65/340/BD/FK1DR1.2/2/180/StQ1	65	700	829
3049/70/340/BD/FK1DR1.2/2/180/StQ1	70	640	817
3050/75/340/BD/FK1DR1.2/2/180/StQ1	75	560	816
3051/80/340/BD/FK1DR1.2/2/180/StQ1	80	500	811

L = appr. 340 mm